

DIAMETAL

Success with precision

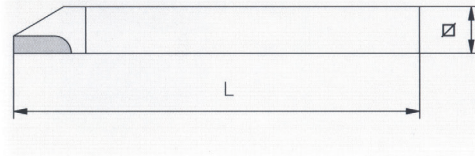

■ Turning tools soldered (초경 터닝 완성 바이트)

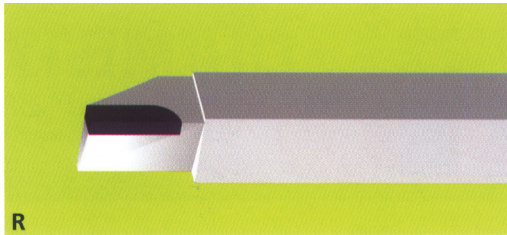

DRAUTDRE

Standard turning tools

Type	Position	∅ x L	K05	MG7.5	MG10	UG8
L	-	6x6x120	200 005	200 007		226 455
L	I	6x6x120		200 009		
L	-	7x7x140	200 011	200 013	210 387	226 457
L	I	7x7x140	200 014	200 015		363 879
L	-	8x8x140	200 017	200 019	210 388	226 458
L	I	8x8x140	200 020	200 021	215 514	
L	-	10x10x150	200 023		210 389	237 306
L	-	12x12x150	200 026		210 390	237 307
R	-	6x6x120	200 004			
R	-	8x8x140	200 016		214 298	364 973
R	-	10x10x150	200 022		214 299	387 252
R	-	12x12x150	200 025		214 300	

■ Head tools soldered

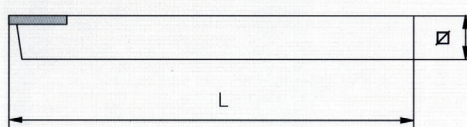

DRAUTKOP

Standard head tools

∅ x L	MG 10
6x6x120	200 070
7x7x140	200 071
8x8x140	200 072
10x10x150	200 073
12x12x150	200 074
14x14x150	200 075

Parting tools soldered (초경 절단 완성바이트)

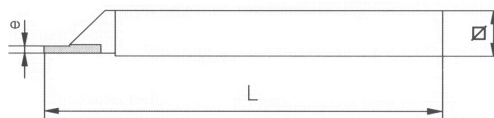

DRAUTSTE

Standard parting tools

Type	∅ x L	e	K05	MG10	UG8
R	7x7x140	1.75	200 040		
R	8x8x140	1.60		384 681	366 593
R	8x8x140	1.75	200 051	384 685	
R	8x8x140	2.00	207 391	214 293	366 321
R	8x8x140	3.00	200 306		
R	10x10x150	1.50	398 375		
R	10x10x150	1.75	200 059		
R	10x10x150	2.00	220 501		
R	10x10x150	2.50	350 841	214 294	
R	10x10x150	3.00		390 853	386 949
R	12x12x150	2.00	206 769		
R	12x12x150	2.50		214 295	
R	12x12x150	2.70	200 064		
R	12x12x150	3.00		214 296	

Parting tools soldered (초경 절단 완성바이트)

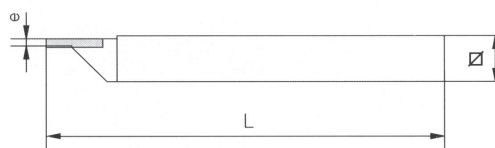
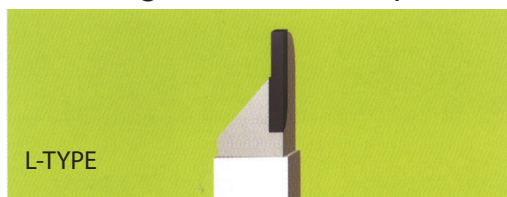

DRAUTSTE

Standard parting tools

Type	∅ x L	e	K05	KG7.5	MG10	UG8
L	5x5x120	1.25	200 032			
L	6x6x120	1.00	200 295	217 582		
L	6x6x120	1.25	200 250	217 583		226 448
L	6x6x120	1.50	218 649	217 584		238 344
L	6x6x120	1.60	200 034	200 036		
L	6x6x120	2.00		215 277		383 312
L	7x7x140	1.25	200 037	217 580		226 450
L	7x7x140	1.50	200 039	200 298		226 451
L	7x7x140	1.60			210 370	
L	7x7x140	1.75	200 041	200 043		
L	7x7x140	2.00	200 044	217 581	210 371	226 452
L	7x7x140	2.50	214 669		210 372	
L	8x8x140	1.50	200 050	216 023		226 453
L	8x8x140	1.60			210 373	
L	8x8x140	1.75	200 052	200 054	387 309	
L	8x8x140	2.00	200 055	206 772	210 374	226 454
L	8x8x140	2.25	200 056			
L	8x8x140	2.50	200 058		210 375	
L	10x10x150	1.75	200 060			
L	10x10x150	2.00	212 188		210 376	237 302
L	10x10x150	2.50	217 418			237 303
L	10x10x150	3.00			210 378	
L	12x12x150	1.50	212 391			
L	12x12x150	2.00	219 678		210 379	
L	12x12x150	2.50	200 313	226 726	210 380	237 304
L	12x12x150	2.70	200 065			
L	12x12x150	3.00	206 803	226 727	210 381	237 305