

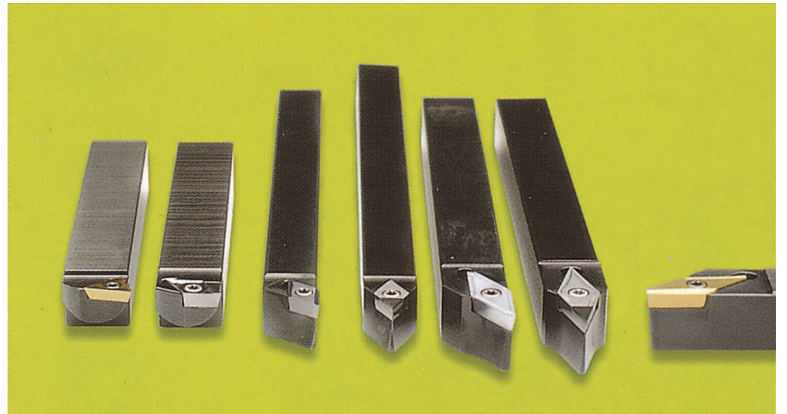

# TOPDEC (톱덱)



1. DIAMETAL

2. BIMU

3. IFANGER

4. ARNO

5. SPHINX

6. ZEUS

7. PRAMET

8. BECKER

9. WHIZCUT

## TOPDEC Precision toolholder (55° Insert)

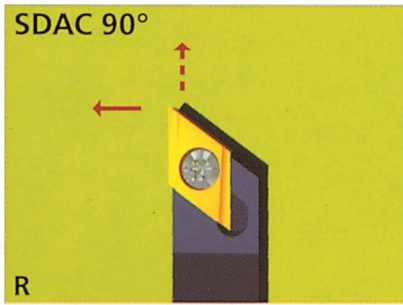

| Toolholder |           |         |      |           |         |
|------------|-----------|---------|------|-----------|---------|
| Type       | □ x L     | Art. No | Type | □ x L     | Art. No |
| L          | 8x8x120   | 234 238 | R    | 8x8x120   | 234 242 |
| L          | 10x10x120 | 234 239 | R    | 10x10x120 | 234 243 |
| L          | 12x12x120 | 234 240 | R    | 12x12x120 | 234 244 |
| L          | 16x16x120 | 234 241 | R    | 16x16x120 | 234 245 |

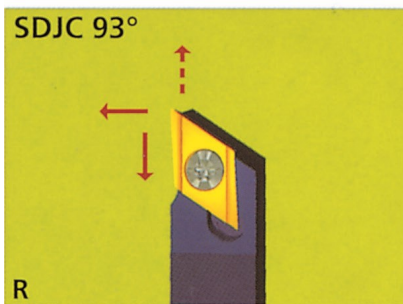

| Toolholder |           |         |      |           |         |
|------------|-----------|---------|------|-----------|---------|
| Type       | □ x L     | Art. No | Type | □ x L     | Art. No |
| L          | 8x8x120   | 300 782 | R    | 8x8x120   | 300 781 |
| L          | 10x10x120 | 300 784 | R    | 10x10x120 | 300 783 |
| L          | 12x12x120 | 300 786 | R    | 12x12x120 | 300 785 |
| L          | 16x16x120 | 300 788 | R    | 16x16x120 | 300 787 |

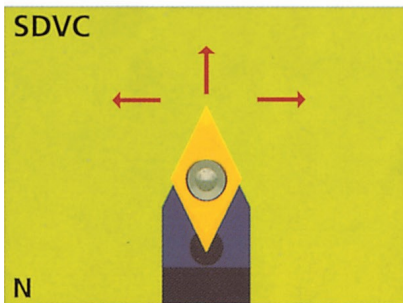

| Toolholder |           |         |
|------------|-----------|---------|
| Type       | □ x L     | Art. No |
| N          | 8x8x120   | 305 373 |
| N          | 10x10x120 | 305 374 |
| N          | 12x12x120 | 305 375 |
| N          | 16x16x120 | 305 376 |

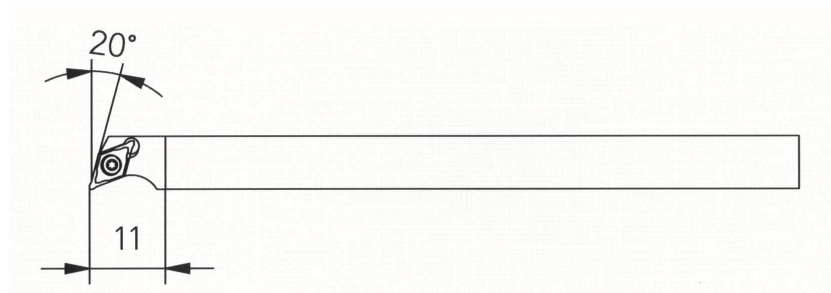
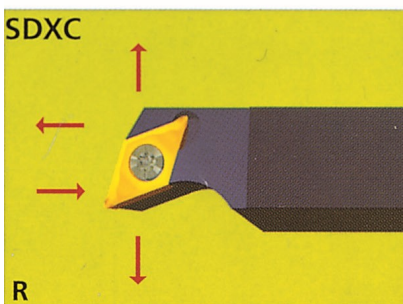

Right holder requires  
L or N insert

| Toolholder |           |         |      |           |         |
|------------|-----------|---------|------|-----------|---------|
| Type       | □ x L     | Art. No | Type | □ x L     | Art. No |
| L          | 12x12x120 | 305 372 | R    | 12x12x120 | 305 371 |

## TOPDEC Turning Inserts (55° Insert)

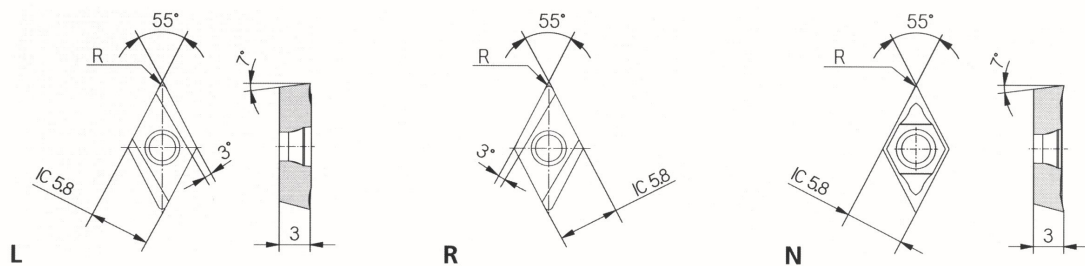

### DCGX

| Insert     |        |            |            |            |            |         |
|------------|--------|------------|------------|------------|------------|---------|
| Size       | Radius | M10/30 D10 | M10/30 D20 | M10/30 D30 | M10/30 D60 | Cermet  |
| 0703003 FL | 0.03   |            | 370 856    |            |            |         |
| 070301 FL  | 0.10   | 236 136    | 234 223    | 236 154    |            | 358 919 |
| 070302 FL  | 0.20   | 236 137    | 234 224    | 236 155    | 391 129    | 358 920 |
| 070304 FL  | 0.40   | 236 138    | 234 225    | 236 156    |            | 358 921 |
| 0703003 FR | 0.03   |            | 369 885    |            |            |         |
| 070301 FR  | 0.10   | 236 145    | 234 220    | 236 157    | 390 950    | 358 916 |
| 070302 FR  | 0.20   | 236 146    | 234 221    | 236 158    | 375 024    | 358 917 |
| 070304 FR  | 0.40   | 236 147    | 234 222    | 236 159    | 401 586    | 358 918 |
| 070301 FN  | 0.10   | 305 339    | 305 341    | 305 343    |            |         |
| 070302 FN  | 0.20   | 305 340    | 305 342    | 305 344    |            |         |

### DCGX/Alu

| Insert    |        |         |
|-----------|--------|---------|
| Size      | Radius | M10/30  |
| 070302 FN | 0.20   | 370 687 |
| 070304 FN | 0.40   | 372 822 |

## TOPDEC Capto C3

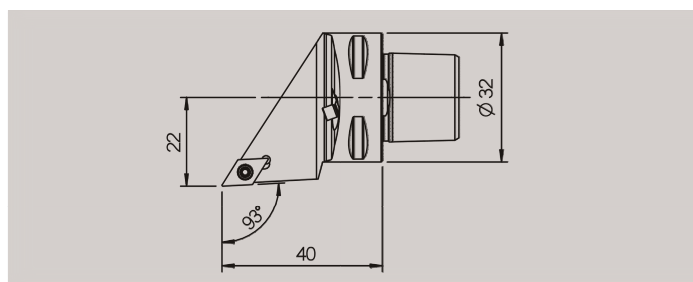

### Toolholder

Typ / Type

Art.-Nr. / Art. No

R

374 974

### TORX Spare parts

Type

Art. No

Screw

TP7 M 2,2 x 6,5

234 212

Screwdriver

TP7

381 682

■ TOPDEC Precision toolholder (35° Insert)

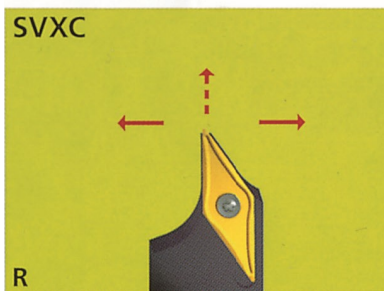
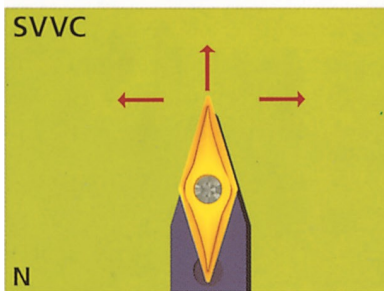
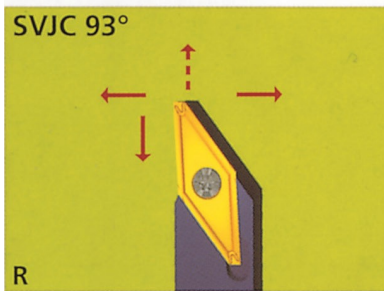
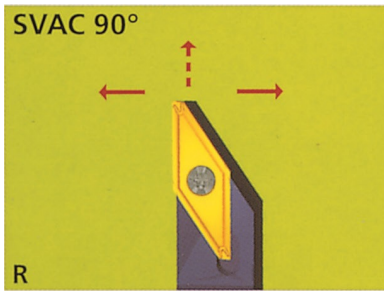

| Toolholder |           |         |      |           |         |
|------------|-----------|---------|------|-----------|---------|
| Type       | □ x L     | Art. No | Type | □ x L     | Art. No |
| L          | 8x8x120   | 234 226 | R    | 8x8x120   | 234 233 |
| L          | 10x10x120 | 234 227 | R    | 10x10x120 | 234 234 |
| L          | 12x12x120 | 234 228 | R    | 12x12x120 | 234 235 |
| L          | 16x16x120 | 234 229 | R    | 16x16x120 | 234 236 |

| Toolholder |           |         |      |           |         |
|------------|-----------|---------|------|-----------|---------|
| Type       | □ x L     | Art. No | Type | □ x L     | Art. No |
| L          | 8x10x120  | 358 497 | R    | 8x10x120  | 358 496 |
| L          | 10x10x120 | 300 774 | R    | 10x10x120 | 300 773 |
| L          | 12x12x120 | 300 776 | R    | 12x12x120 | 300 775 |
| L          | 16x16x120 | 300 778 | R    | 16x16x120 | 300 777 |
| L          | 20x20x120 | 300 780 | R    | 20x20x120 | 300 779 |

| Toolholder |           |         |
|------------|-----------|---------|
| Type       | □ x L     | Art. No |
| N          | 8x8x120   | 234 246 |
| N          | 10x10x120 | 234 247 |
| N          | 12x12x120 | 234 248 |
| N          | 16x16x120 | 234 249 |

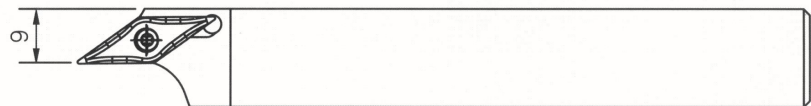

| Toolholder |           |         |      |           |         |
|------------|-----------|---------|------|-----------|---------|
| Type       | □ x L     | Art. No | Type | □ x L     | Art. No |
| L          | 10x10x120 | 377 867 | R    | 10x10x120 | 377 863 |
| L          | 12x12x120 | 377 866 | R    | 12x12x120 | 377 862 |
| L          | 16x16x120 | 377 865 | R    | 16x16x120 | 377 861 |
| L          | 20x20x120 | 377 864 | R    | 20x20x120 | 377 860 |

# 배면 HOLDER(SUB HOLDER)

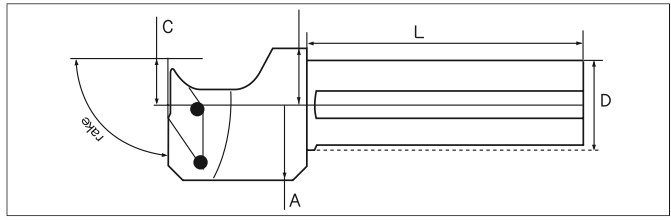

| Description | Dimension(mm)                |       |       |      |       | Spare Parts |             |            |      |
|-------------|------------------------------|-------|-------|------|-------|-------------|-------------|------------|------|
|             | A                            | B     | C     | D    | L     | rake        | Clamp Screw | Wrench     |      |
| 배면 HOLDER   | ∅ 19,05(FOR CINCOM, NEXTURN) | 16,00 | 11,52 | 9,52 | 19,05 | 60          | 92°         | T-7 (VCGX) | FT-7 |
|             | ∅ 20,00(FOR Tsugami)         | "     | "     | "    | 20,00 | "           | "           |            |      |
|             | ∅ 22,00(FOR Star)            | "     | "     | "    | 22,00 | "           | "           |            |      |
|             | ∅ 25,00(FOR HANHWA)          | "     | "     | "    | 25,00 | 70          | "           |            |      |

## TOPDEC Turning inserts (35° Insert)

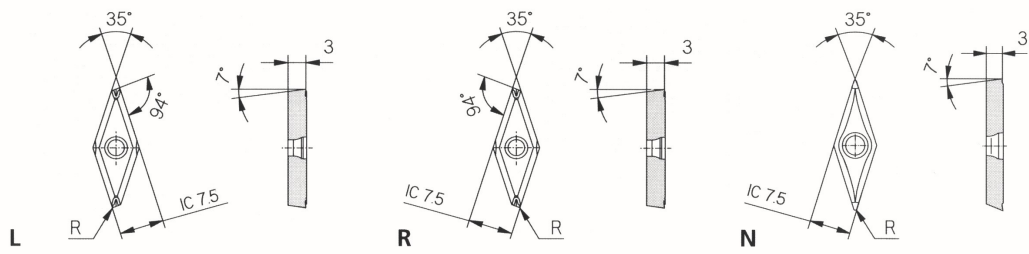

## VCGX

|            |        | Insert     |            |            |            |         |  |
|------------|--------|------------|------------|------------|------------|---------|--|
| Size       | Radius | M10/30 D10 | M10/30 D20 | M10/30 D30 | M10/30 D60 | Cermet  |  |
| 1203000 FL | 0.00   | 236 148    | 234 216    | 236 160    | 405 907    | 301 473 |  |
| 1203008 FL | 0.08   | 236 149    | 234 217    | 236 161    | 387 959    | 301 474 |  |
| 120302 FL  | 0.20   |            |            |            | 403 409    |         |  |
| 1203000 FR | 0.00   | 236 152    | 234 214    | 236 164    | 392 368    | 301 471 |  |
| 1203008 FR | 0.08   | 236 153    | 234 215    | 236 165    | 383 574    | 301 472 |  |
| 120302 FR  | 0.20   |            |            |            | 387 788    |         |  |
| 1203003 FN | 0.03   |            | 406 853    |            |            |         |  |
| 1203005 FN | 0.05   |            | 381 258    |            | 401 859    |         |  |
| 1203008 FN | 0.08   | 367 805    | 367 806    | 367 807    | 400 494    |         |  |
| 120301 FN  | 0.10   |            | 387 892    |            |            |         |  |
| 120302 FN  | 0.20   | 236 150    | 234 218    | 236 162    | 388 948    | 384 543 |  |
| 120304 FN  | 0.40   | 236 151    | 234 219    | 236 163    | 386 354    | 371 948 |  |



## TOPDEC VCGX Turning Inserts

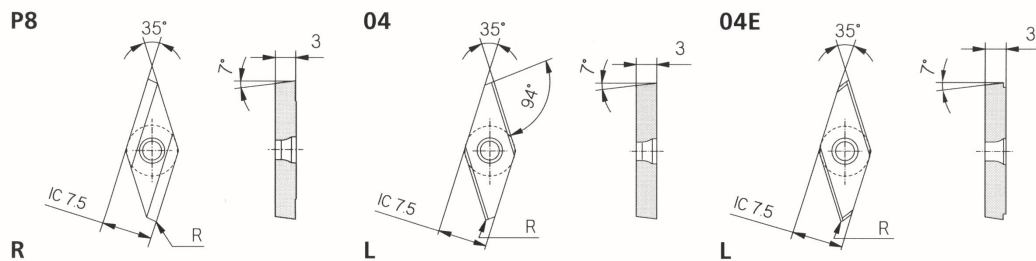

### VCGX/P8

| Insert P8     |        |            |            |            |
|---------------|--------|------------|------------|------------|
| Size          | Radius | M10/30 D10 | M10/30 D20 | M10/30 D30 |
| 1203000-P8 FL | 0.00   |            | 365 208    |            |
| 1203008-P8 FL | 0.08   | 369 299    | 364 924    |            |
| 1203000-P8 FR | 0.00   |            | 364 501    | 364 508    |
| 1203008-P8 FR | 0.08   | 369 300    | 368 858    |            |

### VCGX/04

| Insert 04     |        |            |            |
|---------------|--------|------------|------------|
| Size          | Radius | M10/30 D20 | M10/30 D30 |
| 1203000-04 FL | 0.00   | 361 353    |            |
| 1203008-04 FL | 0.08   | 361 354    |            |
| 1203000-04 FR | 0.00   | 361 352    |            |
| 1203008-04 FR | 0.08   | 361 351    |            |

### VCGX/04E

| Insert 04E     |        |            |            |
|----------------|--------|------------|------------|
| Size           | Radius | M10/30 D20 | M10/30 D30 |
| 1203000-04E FL | 0.00   | 367 835    |            |
| 1203008-04E FL | 0.08   | 367 653    |            |
| 1203000-04E FR | 0.00   | 368 914    |            |
| 1203008-04E FR | 0.08   | 368 916    |            |

## TOPDEC PCD Inserts

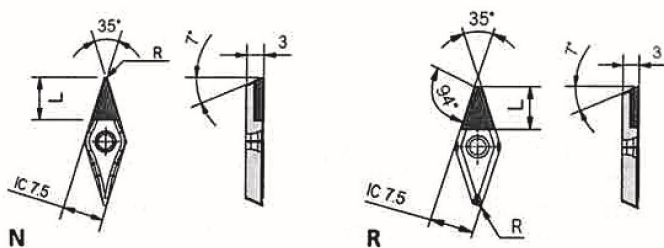
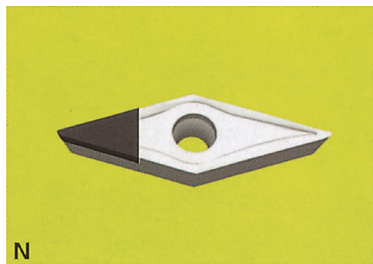

### VCGX

| Insert     |        |     |         |
|------------|--------|-----|---------|
| Size       | Radius | L   | Art. No |
| 1203005 FL | 0.05   | 5.0 | 375 426 |
| 1203005 FR | 0.05   | 5.0 | 392 922 |
| 1203008 FN | 0.08   | 6.0 | 371 916 |
| 120302 FN  | 0.20   | 6.0 | 371 913 |
| 120304 FN  | 0.40   | 6.0 | 371 912 |

# ISO Turning inserts

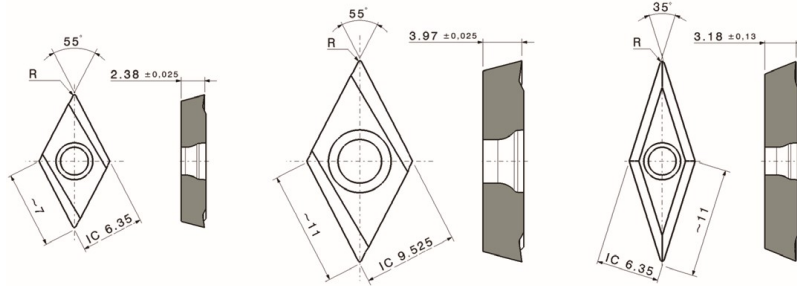

DCET 0702 FL

DCET 11T3 FL

VCGT 1103 FN

## DCET

| Insert  |    |        |               |               |
|---------|----|--------|---------------|---------------|
| Size    |    | Radius | M10/30<br>D20 | M10/30<br>D60 |
| 0702003 | FL | 0.03   | 418229        | 418251        |
| 070201  | FL | 0.1    | 418230        | 418252        |
| 070202  | FL | 0.2    | 418231        | 418253        |
| 070204  | FL | 0.4    | 418232        | 418254        |
|         |    |        |               |               |
| 0702003 | FR | 0.03   | 418233        | 418255        |
| 070201  | FR | 0.1    | 418234        | 418256        |
| 070202  | FR | 0.2    | 418235        | 418257        |
| 070204  | FR | 0.4    | 418236        | 418258        |
|         |    |        |               |               |
| 11T3005 | FL | 0.05   | 418237        | 418259        |
| 11T301  | FL | 0.1    | 418238        | 418260        |
| 11T302  | FL | 0.2    | 418239        | 418261        |
| 11T304  | FL | 0.4    | 418240        | 418262        |
| 11T308  | FL | 0.8    | 418241        | 418263        |
|         |    |        |               |               |
| 11T3005 | FR | 0.05   | 418242        | 418264        |
| 11T301  | FR | 0.1    | 418243        | 418265        |
| 11T302  | FR | 0.2    | 418244        | 418266        |
| 11T304  | FR | 0.4    | 418245        | 418267        |
| 11T308  | FR | 0.8    | 418246        | 418268        |

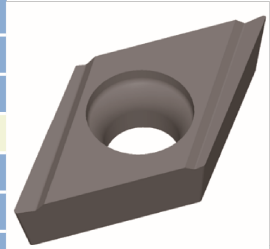
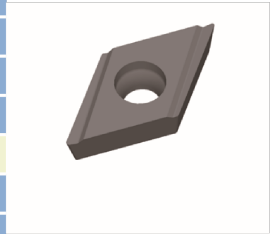

## VCGT

| Insert  |    |        |               |               |
|---------|----|--------|---------------|---------------|
| Size    |    | Radius | M10/30<br>D20 | M10/30<br>D60 |
| 1103005 | FN | 0.05   | 418247        | 418269        |
| 1103008 | FN | 0.08   | 418248        | 418270        |
| 110302  | FN | 0.2    | 418249        | 418271        |

